

# LPFG SERIES- Front Terminal GEL

## LPFG12-150 (12V144AH)

### Specification

Nominal Voltage	12V	
Nominal Capacity(20HR)	144.0AH	
Dimension	Length	551 ± 3mm (21.69 inches)
	Width	110 ± 2mm (4.33 inches)
	Container Height	287 ± 3mm (11.30 inches)
	Total Height (with Terminal)	287 ± 3mm (11.30 inches)
Approx Weight	Approx 47.4 kg (104.5lbs)	
Terminal	T6	
Container Material	ABS	
Rated Capacity	144.0 AH/7.20A	(20hr, 1.80V/cell, 25°C/77°F)
	135.0 AH/13.5A	(10hr, 1.80V/cell, 25°C/77°F)
	118.8 AH/23.76A	(5hr, 1.75V/cell, 25°C/77°F)
	103.5 AH/34.5A	(3hr, 1.75V/cell, 25°C/77°F)
	78.3 AH/78.3A	(1hr, 1.60V/cell, 25°C/77°F)
Max. Discharge Current	1500A (5s)	
Internal Resistance	Approx 3.5mΩ	
Operating Temp. Range	Discharge	-20~55°C (-4~131°F)
	Charge	0~40°C (32~104°F)
	Storage	-20~50°C (-4~122°F)
Nominal Operating Temp. Range	25 ± 3°C (77 ± 5°F)	
Cycle Use	Initial Charging Current less than 36A. Voltage	
	14.4V~15.0V at 25°C(77°F)Temp. Coefficient -30mV/°C	
Standby Use	No limit on Initial Charging Current Voltage	
	13.5V~13.8V at 25°C(77°F)Temp. Coefficient -20mV/°C	
Capacity affected by Temperature	40°C (104°F)	103%
	25°C (77°F)	100%
	0°C (32°F)	86%
Self Discharge	Leoch LPFG series batteries may be stored for up to 9 months at 25°C(77°F) and then a freshening charge is required. For higher temperatures the time interval will be shorter.	



### Applications

- ◆ Telecom application (19 inches or 23 inches power cabinets)
- ◆ UPS, Standby power supply
- ◆ Systems Solar Power
- ◆ Network connection equipment of communication system
- ◆ Power station systems
- ◆ Railway and marine systems
- ◆ Cable TV



### Constant Current Discharge (Amperes) at 25 °C (77°F)

F.V/Time	20min	30min	45min	1h	2h	3h	4h	5h	6h	7h	8h	9h	10h	20h
1.85V/cell	113.4	89.0	67.9	56.9	39.9	30.4	25.2	21.8	18.7	16.6	15.0	13.7	12.9	6.91
1.80V/cell	129.9	99.5	74.9	62.8	43.2	32.6	26.7	22.9	19.7	17.4	15.7	14.4	13.5	7.20
1.75V/cell	146.0	109.4	81.0	67.2	45.8	34.5	28.0	23.76	20.4	18.0	16.2	14.8	13.8	7.34
1.70V/cell	157.3	117.2	86.0	71.1	48.6	35.9	28.9	24.5	21.1	18.6	16.7	15.2	14.1	7.44
1.67V/cell	163.7	121.8	89.0	73.7	49.8	37.0	29.6	25.0	21.4	18.8	16.9	15.4	14.3	7.51
1.60V/cell	177.4	130.3	95.6	78.3	51.8	38.5	30.7	25.8	21.9	19.2	17.2	15.7	14.5	7.62

### Constant Power Discharge (Watts/cell) at 25 °C (77°F)

F.V/Time	20min	30min	45min	1h	2h	3h	4h	5h	6h	7h	8h	9h	10h	20h
1.85V/cell	217.1	171.6	131.7	110.7	78.1	59.6	49.6	43.0	37.1	32.9	29.8	27.2	25.8	13.8
1.80V/cell	245.4	189.9	143.9	121.6	84.0	63.7	52.4	45.0	38.8	34.4	31.1	28.6	26.9	14.3
1.75V/cell	272.8	206.6	154.2	129.5	88.8	67.1	54.7	46.5	40.0	35.5	32.0	29.4	27.4	14.6
1.70V/cell	290.7	219.7	163.1	136.4	93.7	69.7	56.3	47.9	41.4	36.6	32.9	30.1	28.0	14.8
1.67V/cell	299.1	225.2	167.4	140.5	95.7	71.6	57.5	48.7	41.9	37.0	33.4	30.5	28.3	14.9
1.60V/cell	320.6	239.6	178.9	148.4	99.0	74.1	59.5	50.0	42.8	37.7	33.9	31.1	28.8	15.1

# Dimensions

## T6 Terminal

Unit: mm [inches]

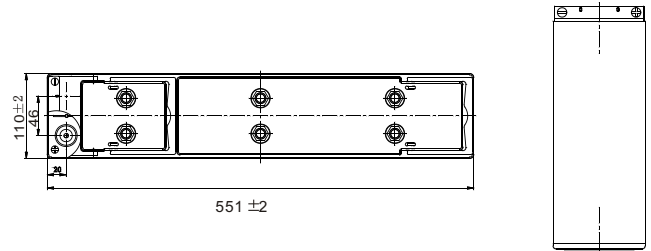
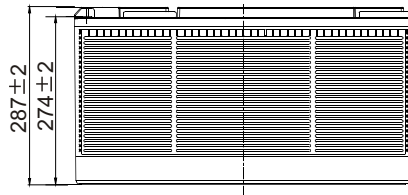
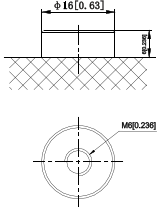

## Discharge Characteristics

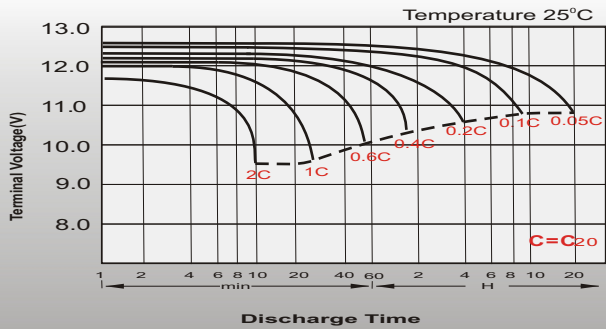

## Float Charging Characteristics

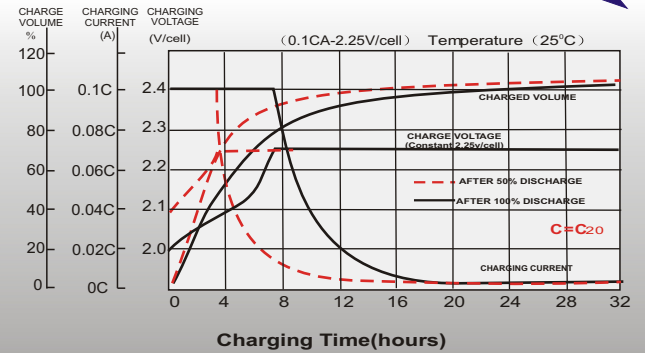

## Temperature Effects in Relation to Battery Capacity

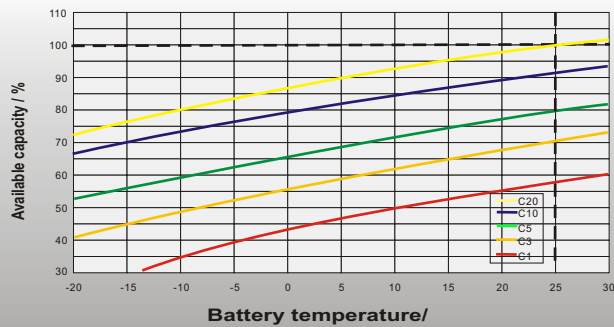

## Effect of Temperature on Long Term Float Life

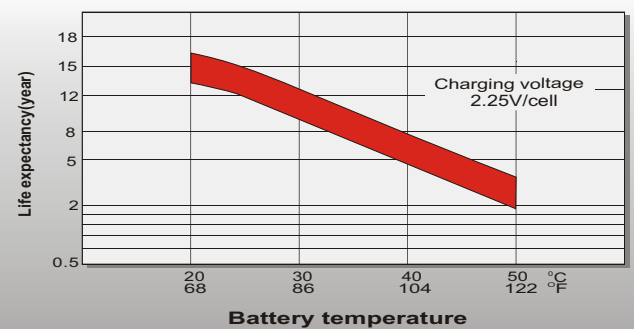

## Cycle Life in Relation to Depth of Discharge

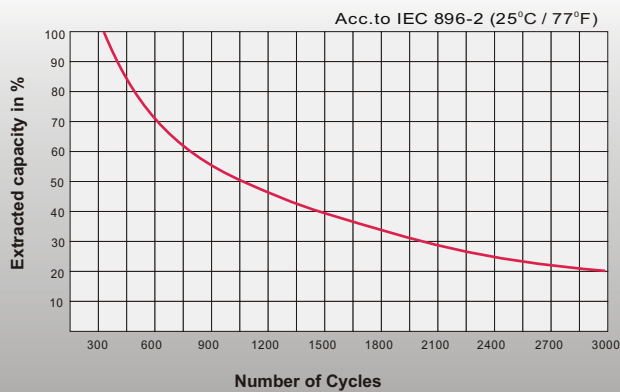

## General Relation of Capacity VS. Storage Time

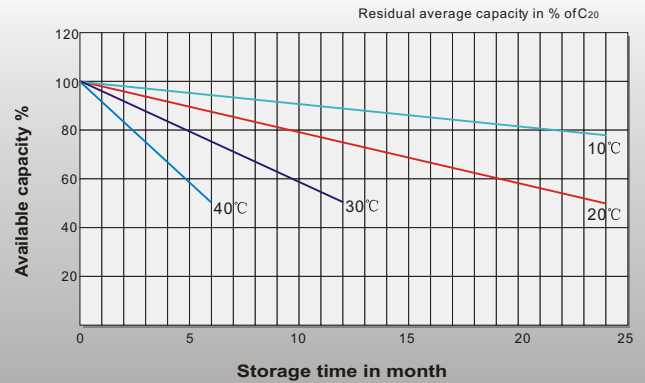

## Sales Office

### China sales office:

Add:5th Floor,Xinbaohui Bldg.,Nanhai Blvd.,  
Nanshan,Shenzhen, China. 518052  
Tel:+ 86-755-86036060 (100 lines)  
Fax: +86-755-26067269  
E-mail:export@leoch.com  
Http://www.leoch.com

### HongKong sales office:

Add: Workshop C, 33/F, TML Tower,  
No. 3 Hoi Shing Road, Tsuen Wan,  
New Territories, Hong Kong  
Tel: +852 35786666  
Fax: +852 21170016  
E-mail: sales.hk@leoch.com

### Singapore sales office:

Add: No. 1 Tech Park Crescent,  
Singapore 638131  
Tel: +65 68416629  
Fax: +65 68443210  
Email: sales.sg@leoch.com

### North America sales office:

Add: 19751 Descartes, Unit A,  
Foothill Ranch, CA 92610, USA  
Tel: 949-588-5853  
Fax: 949-588-5966  
E-mail: sales@leoch.us  
Http://www.leoch.com

### Europe sales office:

Add: 9B Wheatstone Court, Waterwells  
Business Park, Gloucester, GL2-2AQ,  
UK United Kingdom  
Tel: +44(0) 1452 729428 / 1452 729696  
Fax: +44 (0)1452-690125  
E-mail: Sales.Europe@leoch.com